

# TA 900 iSi



**Ball valves**

DN 10-50



Engineering  
**GREAT** Solutions

# TA 900 iSi

Soft-sealing for complete ease-of-use, the TA 900 iSi ball valve is suitable for use in heating, cooling and tap water systems. KOMBI connections enable smooth installation.

## Key features

- > **Soft-sealing**  
For optimum manoeuvrability.
- > **AMETAL®**  
Dezincification resistant alloy that guarantees a longer valve lifetime, and lowers the risk of leakage.
- > **Removable lid**  
For straightforward maintenance.



## Technical description

### Applications:

Heating and cooling systems  
Tapwater systems  
Process systems where the media does not affect the incoming material.

### Function:

Shut-off

### Dimensions:

DN 10-50

### Pressure class:

PN 16

### Temperature:

#### 58 940:

Max. working temperature: 120°C  
Min. working temperature: -20°C

#### 58 950:

Max. working temperature: 90°C  
Min. working temperature: -20°C

### Material:

Valve body: Die cast AMETAL®  
Ball: Chrome plated AMETAL®, double nickel  
Handle: Glass fibre re-inforced polyamid plastic  
Rating plate: Acetal plastic  
Cover screws: Stainless steel (The valve has cover screws for DN 32-50, DN 10-25 has a threaded top section)  
Seat elements and O-rings: 58 940: EPDM rubber, 58 950: Nitrile rubber  
Handle reduction unit: Nickel-plated die-cast zinc alloy  
Control handle: Glass fibre re-inforced plastic

AMETAL® is the dezincification resistant alloy of IMI Hydronic Engineering.

### Surface treatment:

Nickel plated

### Marking:

TA, DR, DN, PN

## For domestic water and water with antifreeze

**EPDM rubber**

**Max. working temperature: 120°C**

**Min. working temperature: -20°C**

**Note!** Not suitable for LPG or medical gases.

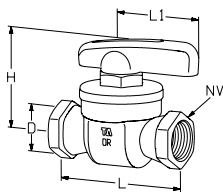

### With red handle

DN	D	L	L1	H	NV	Kvs	EAN	Article No
10	G3/8	59	45,5	48	22	6	7318793351708	58 940-110
15	G1/2	74	45,5	52	27	12	7318793351807	58 940-115
20	G3/4	80	59	63	32	30	7318793351906	58 940-120
25	Rp1	91	59	69	41	65	7318793352002	58 940-125
32	Rp1 1/4	110	79	87	50	90	7318793352101	58 940-132
40	Rp1 1/2	120	79	93	58	150	7318793352200	58 940-140
50	Rp2	141	79	99	70	220	7318793352309	58 940-150

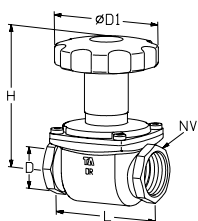

### Fitted with red handle reduction unit

DN	D	D1	L	H	NV	Kvs	EAN	Article No
32	Rp1 1/4	110	110	130	50	90	7318793352408	58 940-732
40	Rp1 1/2	110	120	135	58	150	7318793352507	58 940-740
50	Rp2	110	141	142	70	220	7318793352606	58 940-750

1) Prepared for KOMBI. KOMBI compression couplings are ordered separately. For more information see KOMBI catalogue leaflet.

Kvs = m<sup>3</sup>/h at a pressure drop of 1 bar and fully open valve.

## Universal

**Nitrile rubber**

**Max. working temperature: 90°C**

**Min. working temperature: -20°C**

**Note!** Not suitable for LPG or medical gases.

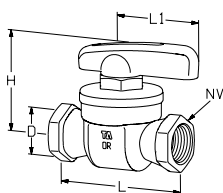

### With blue handle

DN	D	L	L1	H	NV	Kvs	EAN	Article No
10	G3/8	59	45,5	48	22	6	7318793352705	58 950-110
15	G1/2	74	45,5	52	27	12	7318793352804	58 950-115
20	G3/4	80	59	63	32	30	7318793352903	58 950-120
25	Rp1	91	59	69	41	65	7318793353009	58 950-125
32	Rp1 1/4	110	79	87	50	90	7318793353108	58 950-132
40	Rp1 1/2	120	79	93	58	150	7318793353207	58 950-140
50	Rp2	141	79	99	70	220	7318793353306	58 950-150

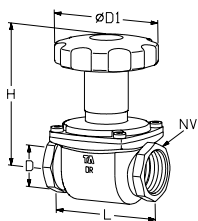

### Fitted with blue handle reduction unit

DN	D	D1	L	H	NV	Kvs	EAN	Article No
32	Rp1 1/4	110	110	130	50	90	7318793353405	58 950-732
40	Rp1 1/2	110	120	135	58	150	7318793353504	58 950-740
50	Rp2	110	141	142	70	220	7318793353603	58 950-750

1) Prepared for KOMBI. KOMBI compression couplings are ordered separately. For more information see KOMBI catalogue leaflet.

Kvs = m<sup>3</sup>/h at a pressure drop of 1 bar and fully open valve.

## Spare parts TA 900 iSi

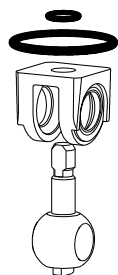
**Spare parts kit for 58 950**

Nitrile rubber (max. 90°C)

**Note!** Not suitable for LPG or medical gases.

For DN	EAN	Article No
10	7318793350008	58 900-010
15	7318793350107	58 900-015
20	7318793350206	58 900-020
25	7318793350305	58 900-025
32	7318793350404	58 900-032
40	7318793350503	58 900-040
50	7318793350602	58 900-050

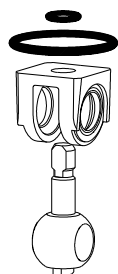
**Spare parts kit for 58 940**

EPDM rubber (max. 120°C)

**Note!** Not suitable for LPG or medical gases.

For DN	EAN	Article No
10	7318793350701	58 910-010
15	7318793350800	58 910-015
20	7318793350909	58 910-020
25	7318793351005	58 910-025
32	7318793351104	58 910-032
40	7318793351203	58 910-040
50	7318793351302	58 910-050

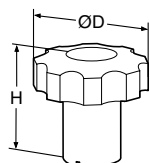
**Handle reduction unit**

For DN	ØD	H	Colour	EAN	Article No
32-50	110	80	Blue	7318793353702	58 980-032
32-50	110	80	Red	7318793353801	58 981-032